

PLAN RDC
Echelle 1/50°

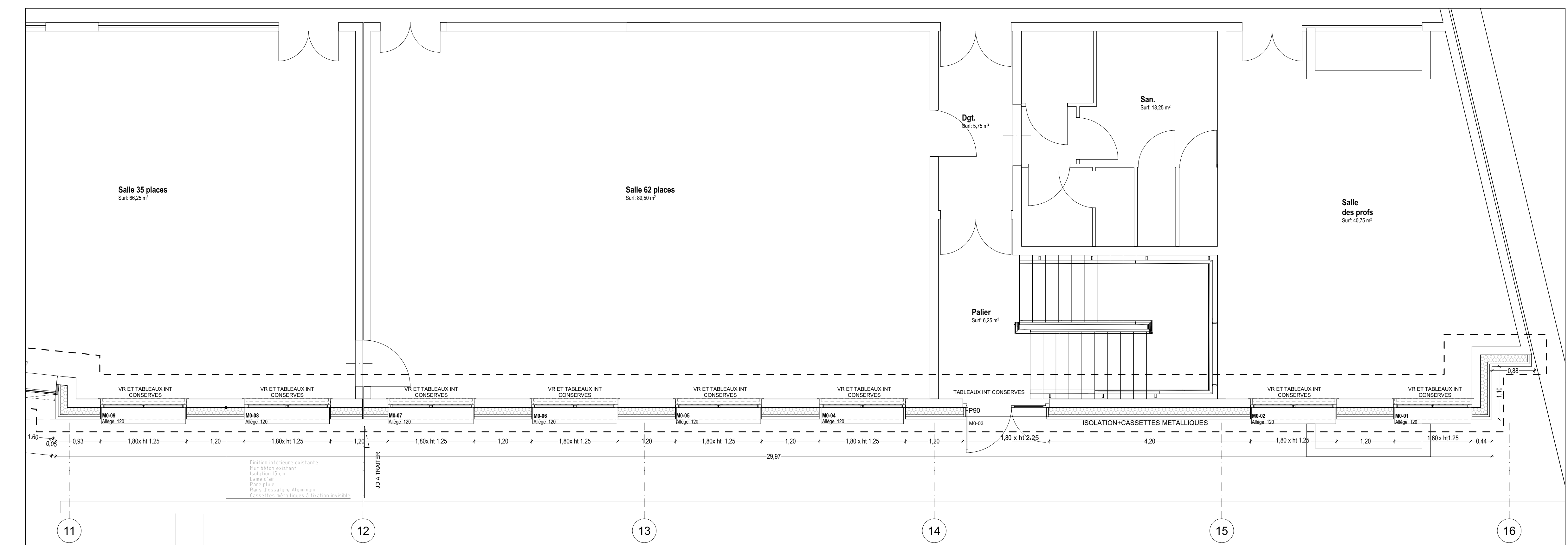

③ ISOLATION FACADE ET BARDAGE METALLIQUE
Echelle 1/50°

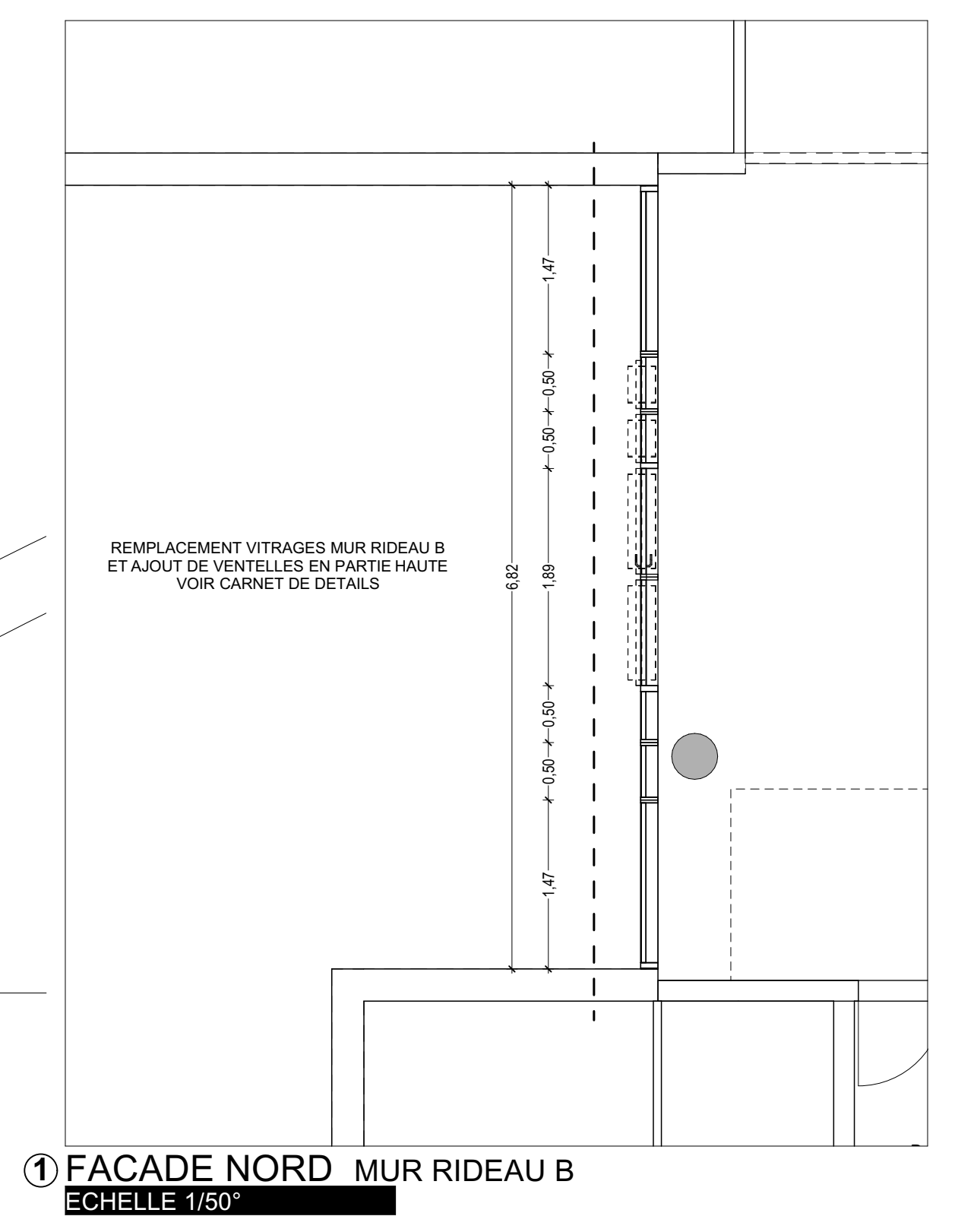



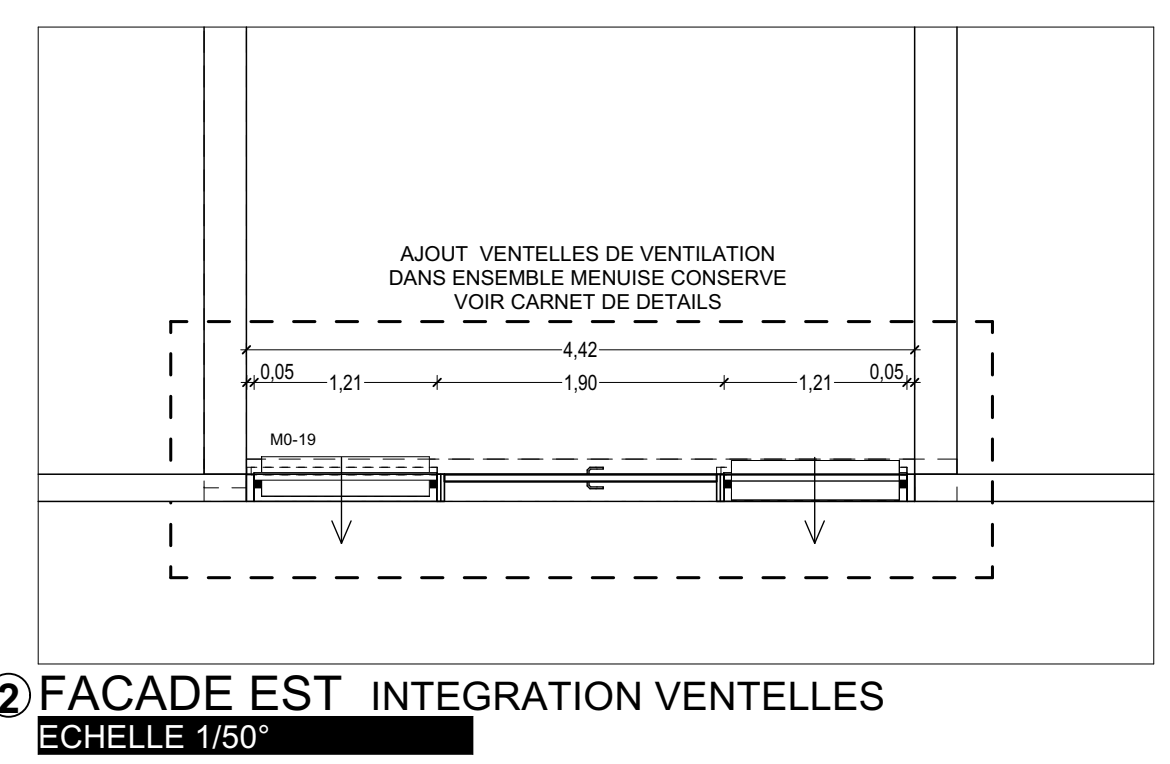

① FACADE NORD MUR RIDEAU B
Echelle 1/50°

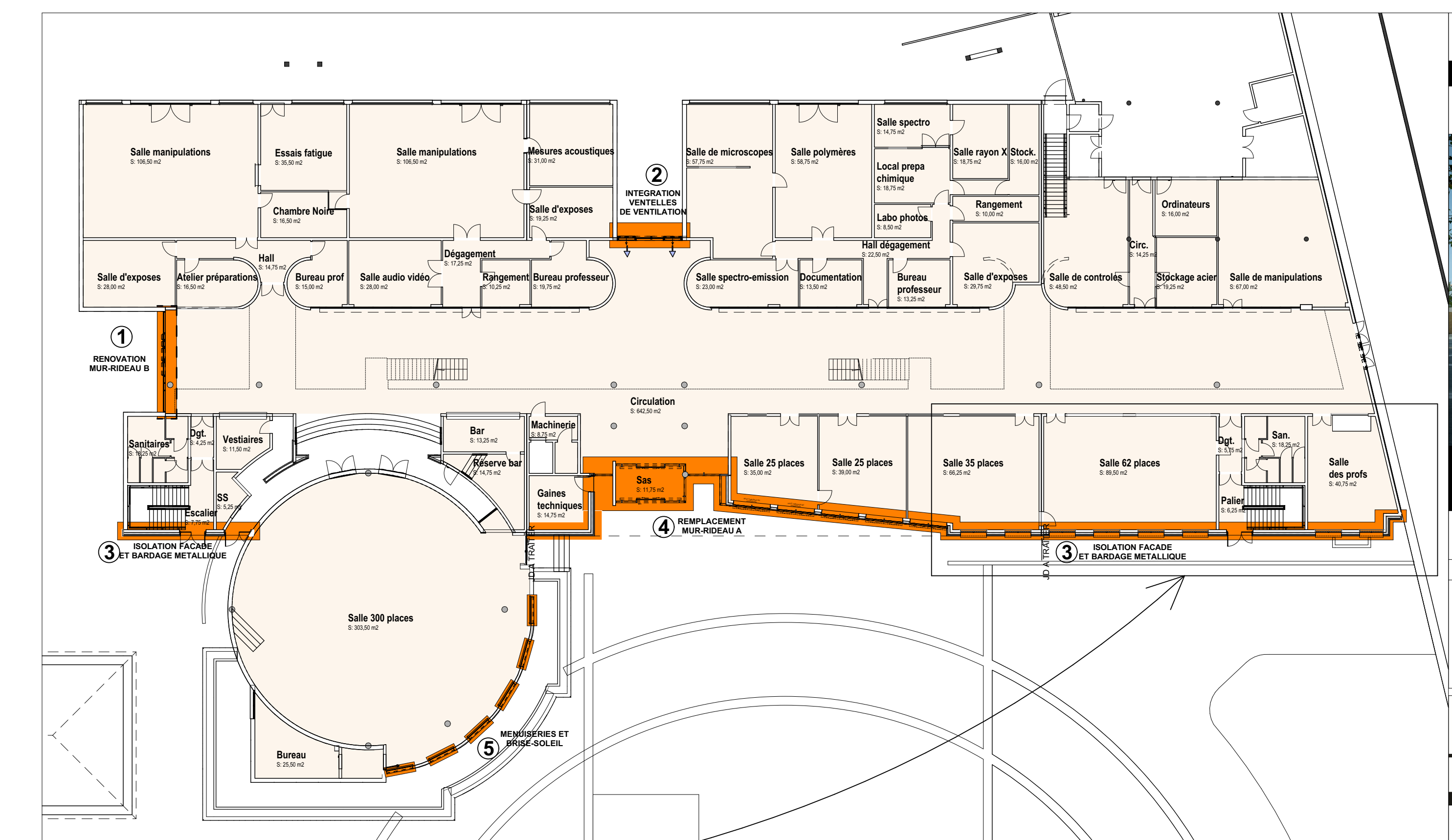

② FACADE EST INTEGRATION VENTELLES
Echelle 1/50°



LOCALISATION INTERVENTIONS
Echelle 1/250°

BATIMENT R DE L'E.N.S.A.M. 2 boulevard du Ronceray 49 000 ANGERS	
MAITRE D'OUVRAGE RECTORAT DE L'ACADEMIE DE NANTES 44 320 NANTES 8 rue du Général Marguerite	
	24/09/2021
	405
PLAN RDC	1:50, 1:250
MODIFICATIONS	DATES
 EDIFICES ARCHITECTES ARCHITECTES ARCHITECTE D.P.L.G. 17 rue de la République 49100 ANGERS 02 41 81 81 81 edifices@edifices-architectes.fr	
 TECHNIQUES ET CHANTIERS ECONOMISTE 17 rue de la République 49100 ANGERS 02 41 81 81 81 techniques@techniques-et-chantiers.fr	
 ISOCRATE BET FLUIDES 17 rue de la République 49100 ANGERS 02 41 81 81 81 isocrate@isocrate.fr	
 EVEN STRUCTURES BET STRUCTURE 17 rue de la République 49100 ANGERS 02 41 81 81 81 even@even-structures.fr	